



**STUART  
CHARLES**  
ESTATE AGENTS



## Constable Road

, Corby, NN18 0RT

£160,000





# Constable Road

, Corby, NN18 0RT

£160,000



## Entrance Hall

Entered via a glazed door, radiator, stairs rising to first floor landing, door to:

## Lounge/Diner

Glazed window to front and rear elevation, two radiators, tv point, telephone point, door to:

## Kitchen

Fitted to comprise a range of base and eye level units with a one and half bowl steel sink and drainer, space for free standing range cooker, space for automatic washing machine, pantry cupboard, glazed window and door to rear elevation.

## First Floor Landing

Loft Access, door to;

## Bedroom One

Glazed window to front elevation, radiator,

## Bedroom Two

Glazed window to front elevation, radiator.

## Bedroom Three

Glazed window to rear elevation, radiator.

## Bathroom

Fitted to comprise a two piece suite consisting of a panel bath with mains feed shower, low level wash hand basin, radiator, glazed window to rear elevation.

## Outside

FRONT - Unseeded lawn with footpath leading to front elevation, enclose by mature shrubbery.

REAR - Large unseeded lawn, enclosed by timber fencing to all sides.

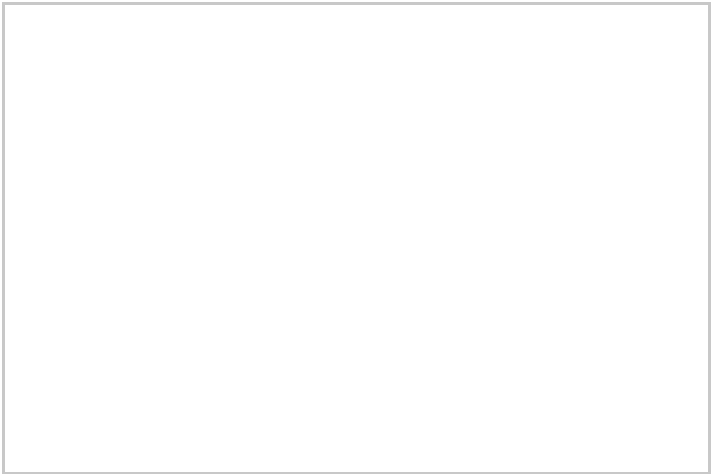
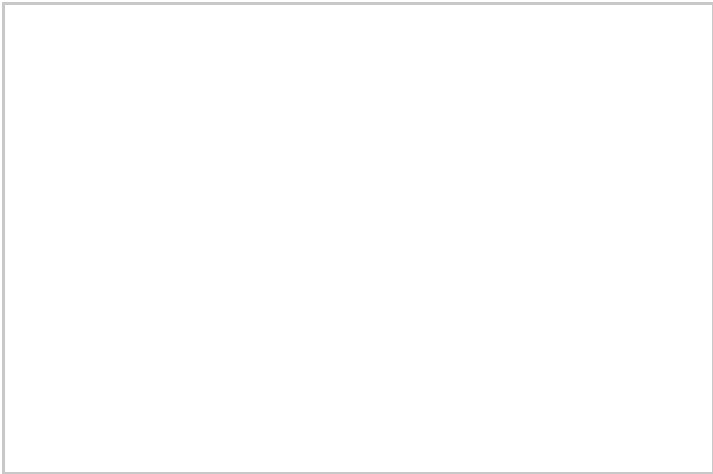
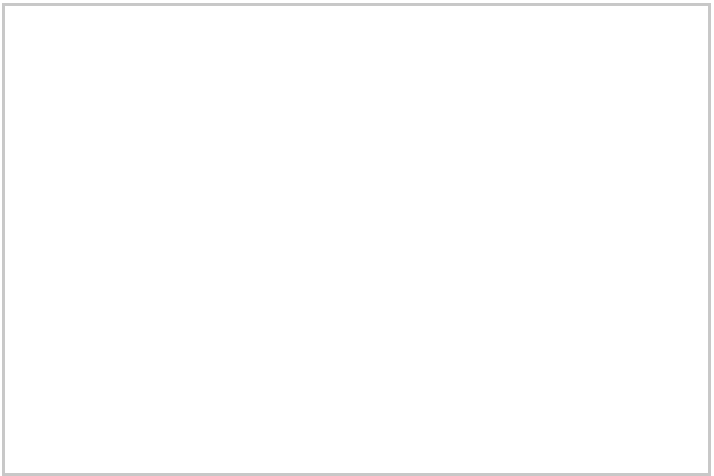
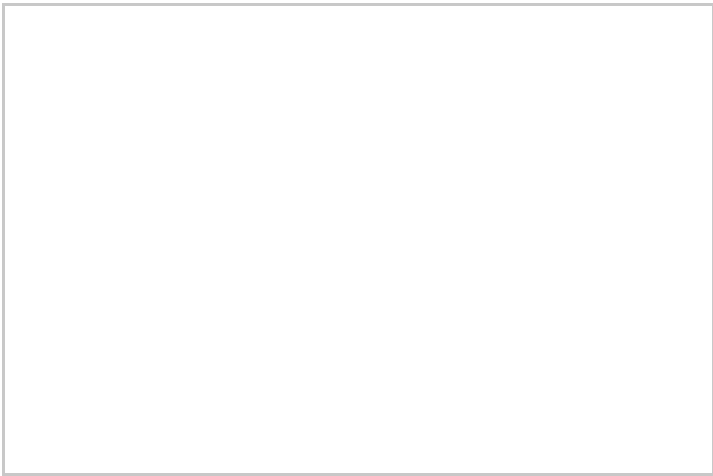

Road Map



Hybrid Map



Terrain Map



Floor Plan

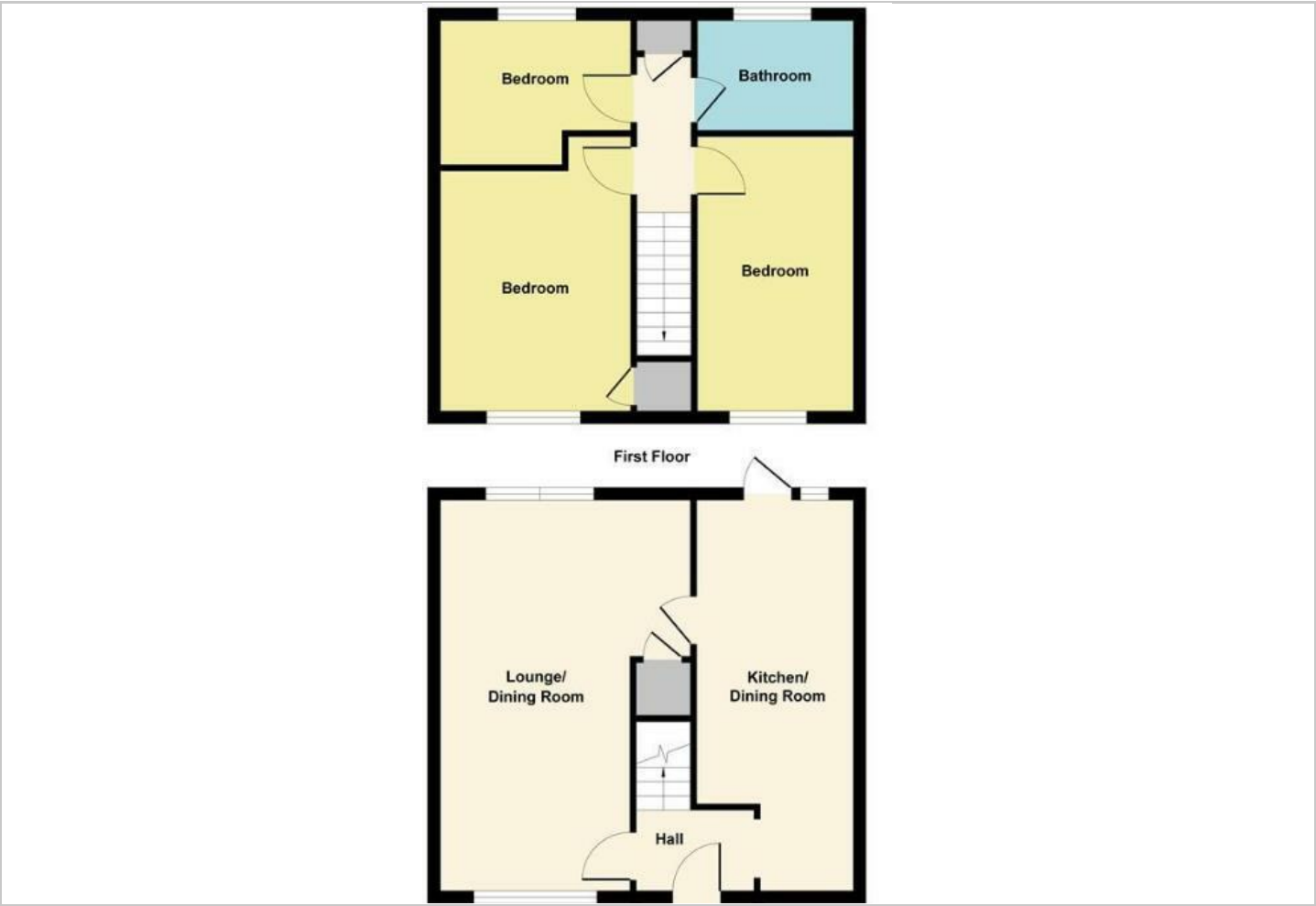

Viewing

Please contact our Stuart Charles Estate Agents Office on 01536 234264 if you wish to arrange a viewing appointment for this property or require further information.

Energy Efficiency Graph

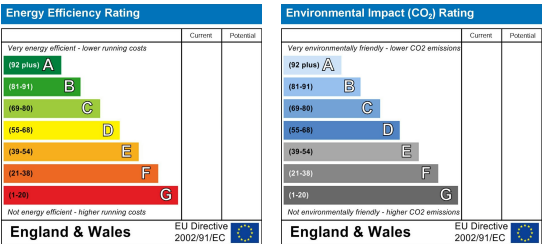

These particulars, whilst believed to be accurate are set out as a general outline only for guidance and do not constitute any part of an offer or contract. Intending purchasers should not rely on them as statements of representation of fact, but must satisfy themselves by inspection or otherwise as to their accuracy. No person in this firms employment has the authority to make or give any representation or warranty in respect of the property.